

PLEASE READ THESE INSTRUCTIONS CAREFULLY BEFORE INSTALLATION
LEAVE A COPY FOR THE USER / MAINTENANCE ENGINEER FOR FUTURE REFERENCE

IMPORTANT INSTALLATION INFORMATION

1. Before commencing installation or maintenance, ensure electricity is switched off at the mains. Installation or maintenance should be carried out by a qualified electrician.
2. If the external flexible cable or cord of this luminaire is damaged, it shall be exclusively replaced by the manufacturer or his service agent or a similar qualified person in order to avoid a hazard.
3. Ensure there is adequate free air circulation of at least 50cm around the luminaire. All luminaires run hot. It is the installer's responsibility to consider fire risk and take appropriate precautions.

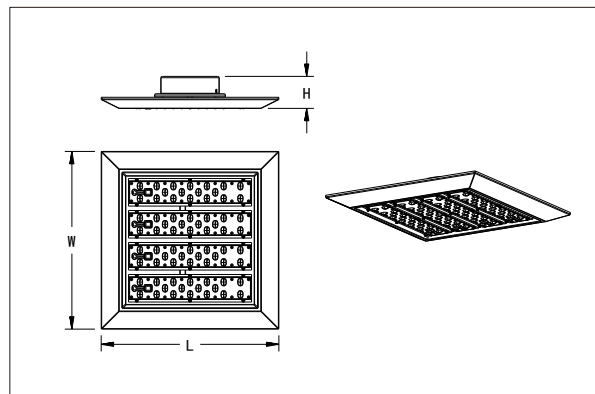

Main specifications:

Model No.	Nominal Wattage	Dimensions (L x W x H)	Net Weight	Gross Weight	Cut-out
LGC: 120-277VAC or 220-240VAC, LGC120: 30w/module, LGC160: 40W/module					
LGC-120	120w	400mm(15.75")x400mm(15.75")x73.4mm(2.89")	3.68kg(8.09lbs.)	4.72 kg (17.02 lbs)	Φ127(mm) Φ5"
LGC-160	160w	400mm(15.75")x400mm(15.75")x73.4mm(2.89")	3.68kg(8.09lbs.)	4.72 kg (17.02 lbs)	Φ127(mm) Φ5"
LGC*H: 347-480VAC, LGC120H: 30w/module, LGC160H: 40W/module					
LGC-120H	120w	400mm(15.75")x400mm(15.75")x73.4mm(2.89")	3.68kg(8.09lbs.)	4.72 kg (17.02 lbs)	Φ127(mm) Φ5"
LGC-160H	160w	400mm(15.75")x400mm(15.75")x73.4mm(2.89")	3.68kg(8.09lbs.)	4.72 kg (17.02 lbs)	Φ127(mm) Φ5"

LGC Series Gas Station Luminaire

INSTALLATION INSTRUCTION

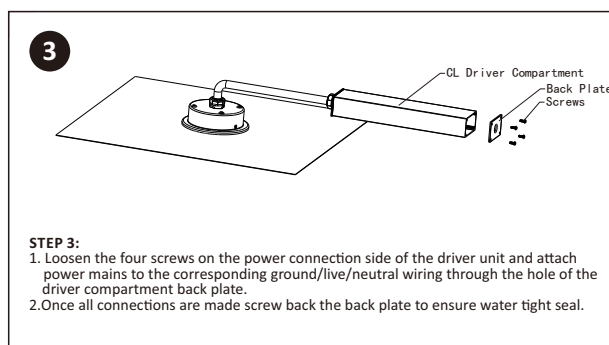
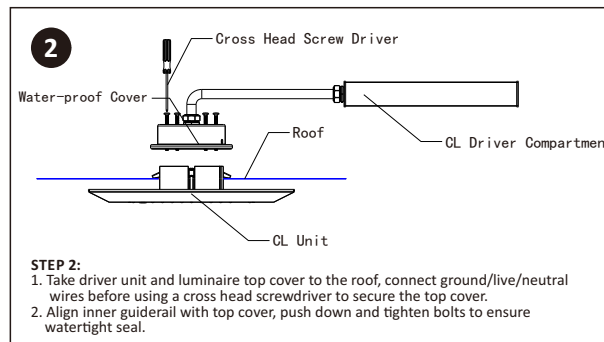
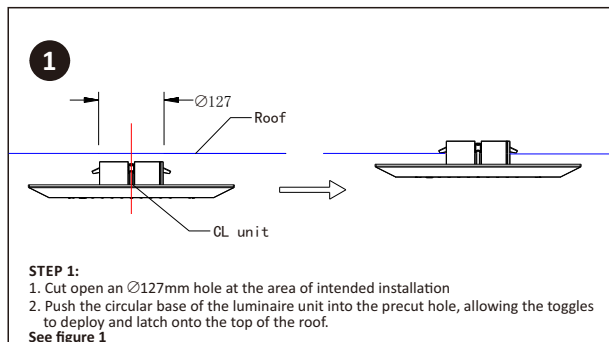

WIRING INSTRUCTION

***IF THERE IS JUNCTION BOX IN CEILING:

STEP I: Connect the LINE wire in the mains power supply cord to black LINE wire from lightbody via a terminal block.

STEP II: Connect the NEUTRAL wire in the mains power supply cord to white NEUTRAL wire from lightbody via a terminal block.

STEP III: Connect the green grounding wire in the mains power supply cord to green grounding wire from lightbody via a terminal block.

STEP III: Push back the connected wires into junction box.

***EXTERNAL JUNCTION BOX:

STEP I: Open the lid of the external junction box.

STEP II: Connect the LINE wire in the mains power supply cord to the L marked hole in the terminal block from the external junction box, and tighten the connection properly.

STEP III: Connect the NEUTRAL wire in the mains power supply cord to the N marked hole in the terminal block from the external junction box, and tighten the connection properly.

STEP IV: Connect the YELLOW/GREEN GROUNDING wire in the mains power supply cord to the G marked hole in the terminal block from the external junction box, and tighten the connection properly.

STEP V: Close the junction box, and fasten the screws to fix the lid to the junction box body.

Alternating Current

Input wire H07RN-F 3x1.5mm² (SJOW 3 * 18AWG) or rubber sheathed cable (not supplied). Conductor must have a minimum cross-sectional area of 1.0mm² (18AWG).

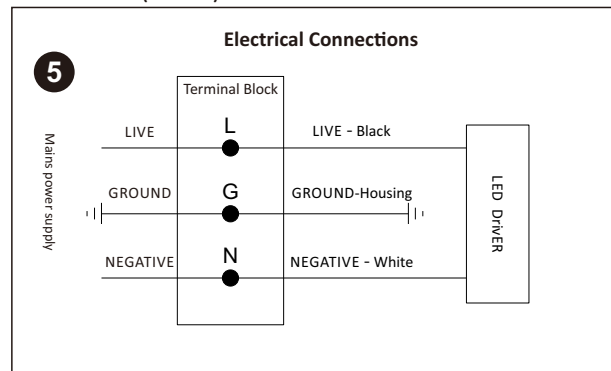

This logo indicates that this product must not be disposed of with other waste. Please recycle used lamps to prevent environmental hazard and threats to human health resulting from improper disposal.