

CONCRETE POUR KIT / SLEEVE

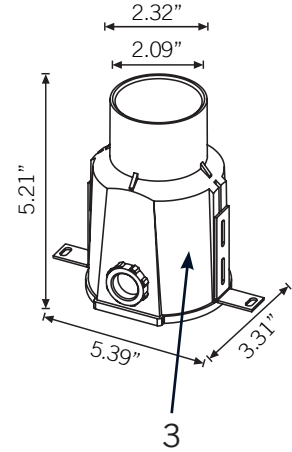

- 1) Front cover
- 2) Spring clip
- 3) Mounting sleeve/ concrete pour kit

CONCRETE INSTALLATION

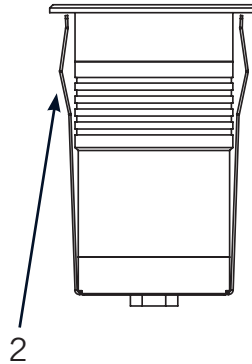
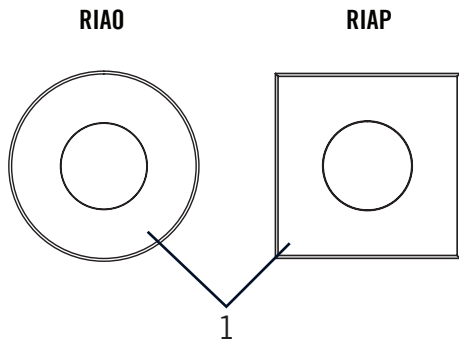
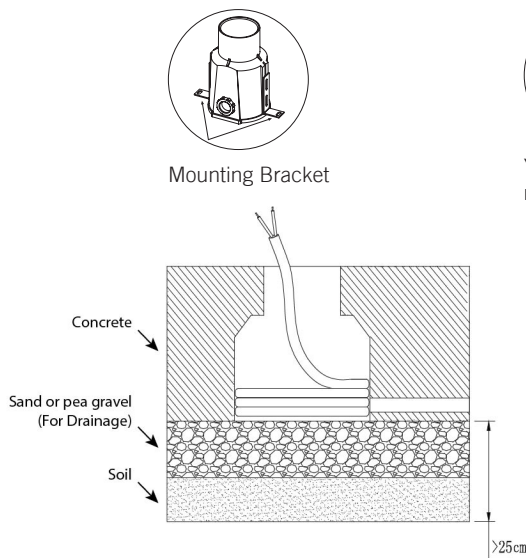

Install wiring and conduit into sleeve at the desired position. Secure the sleeve to the bottom of the application ground by using brackets provided.

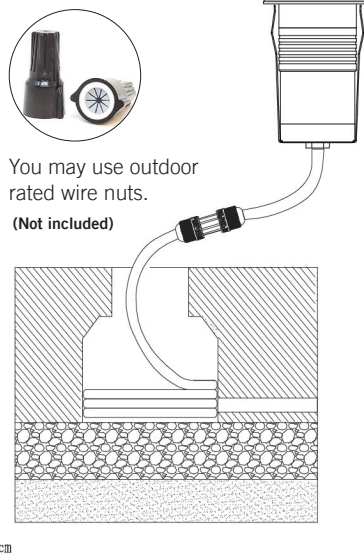

After concrete has cured, connect the wires using IP68 connector, or outdoor rated wire nuts. (IP68 connector, or outdoor rated wire nut, Not included)

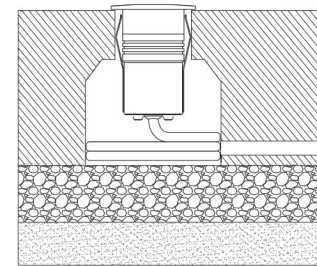

Place light fixture into the sleeve.

Note: NO CONCRETE ENTERS THE BOX. USE SAND OR GRAVEL FOR PROPER DRAINAGE.

SOIL INSTALLATION

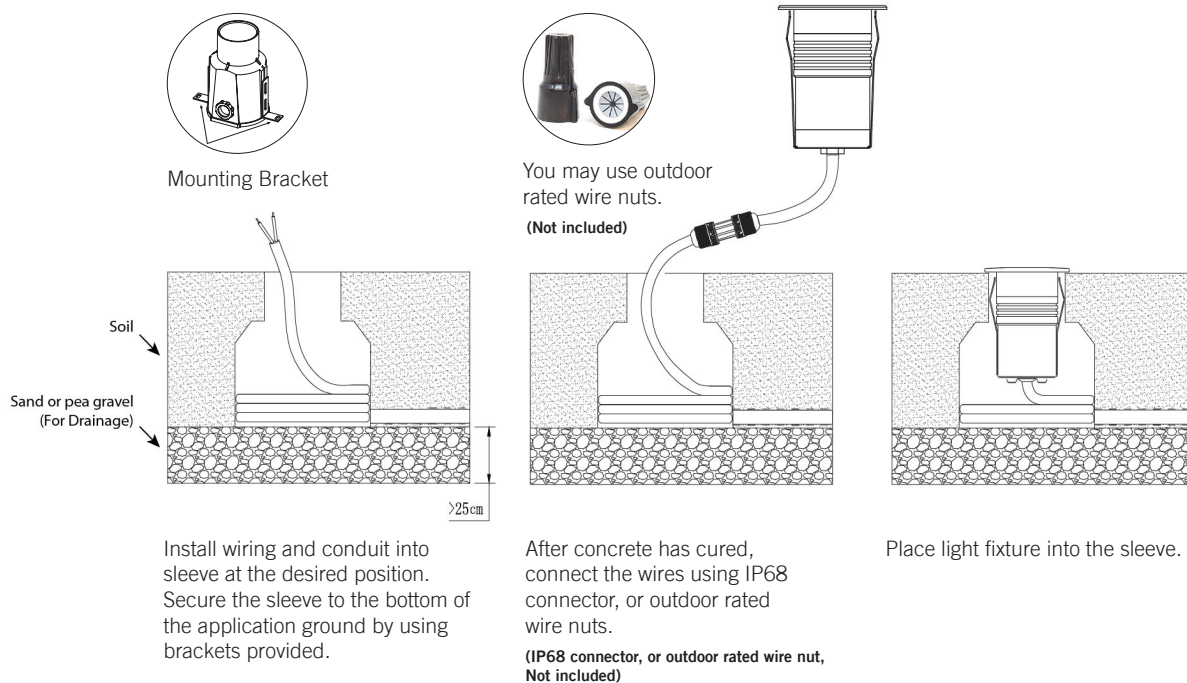

Note: USE SAND OR GRAVEL FOR PROPER DRAINAGE.

