

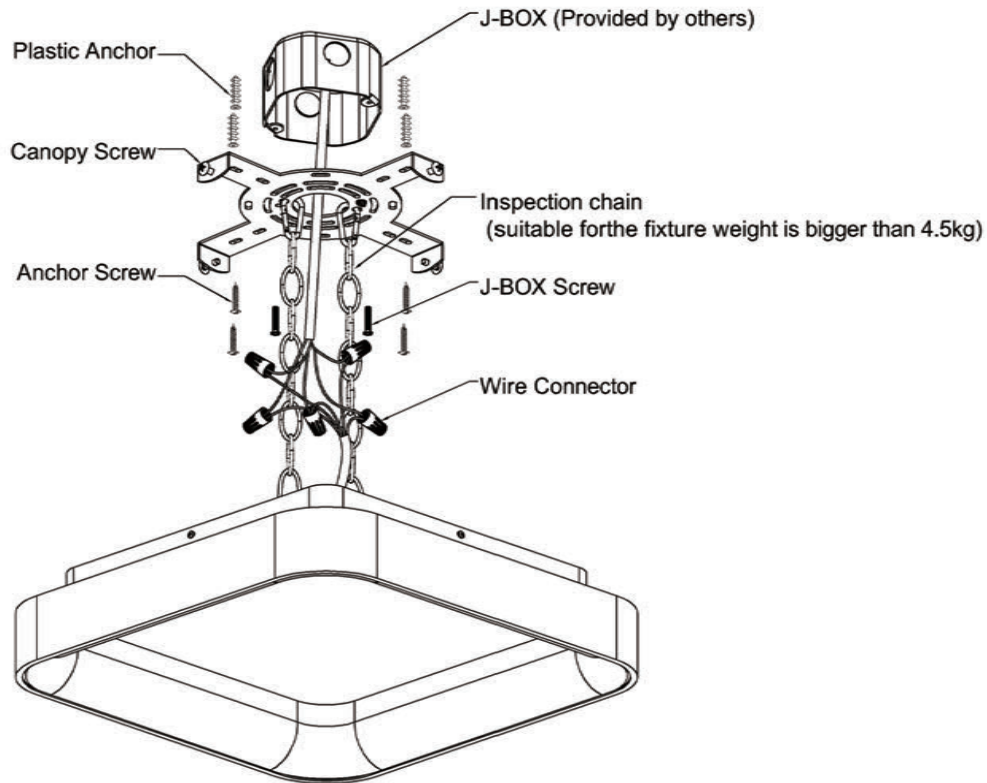

Please read this installation manual carefully before installation, keep it for future reference! Products are well packed and performing well before leaving our factory. Please strictly follow the instructions listed in the manual. Factory or distributor shall not be held responsible for any misoperation or damage caused by not following up the manual!

Installation Diagram



Step 1

Shut "OFF" the electricity at the main fuse box.

Place the wall switch in the "OFF" position of the room where you are installing the fixture.

Tools You May Need

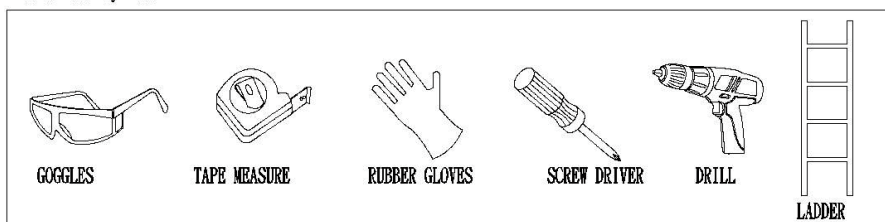

Circuit Box

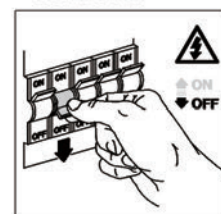

Step 2

Use a screw driver to relieve the Canopy screw a little. (Not take out). Rotate the Mounting Bracket and take it out from the Bottom Bracket as below.

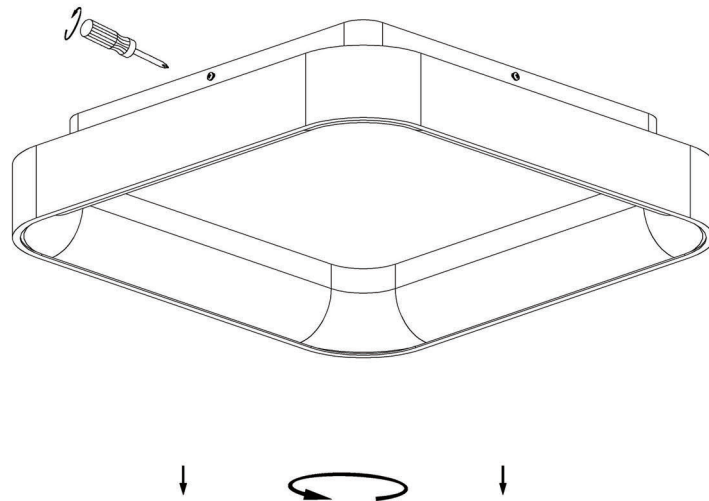
**Step 3**

Make point marks on the ceiling according to the Mounting pin and Canopy location.

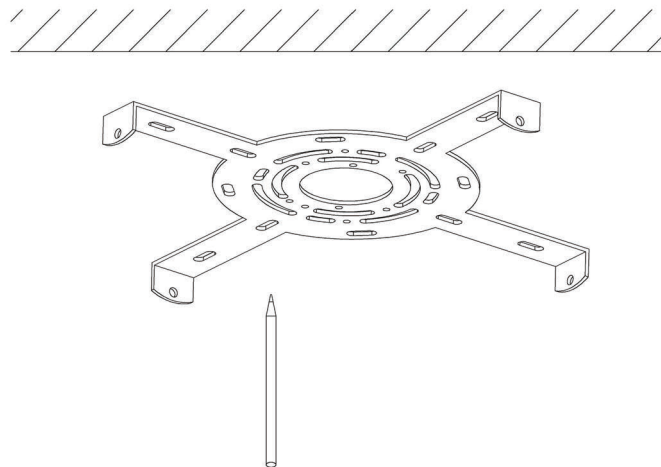
**Step 4**

Take out Plastic Anchors, and drill 4 pcs or 8 pcs diameter 8mm holes on the ceiling according to the Mounting Bracket. Insert the Plastic Anchors into the holes. Use 2 pcs J-BOX Screws to fix the Mounting Bracket with J-Box, refer to the picture shown below.

NOTE: J-BOX used by Garvin 54171-S or equivalent Provided by others.

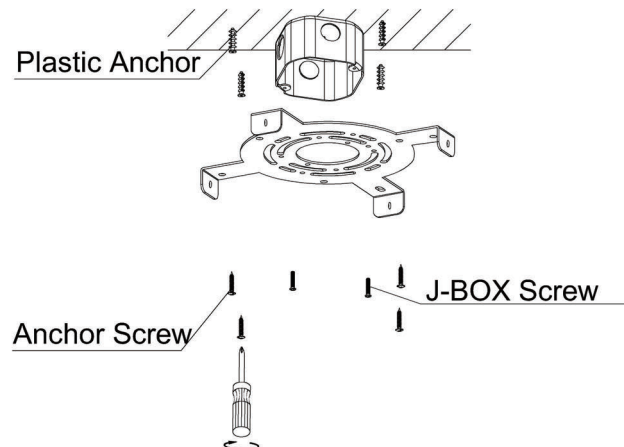
**Step 5**

Use 4 pcs or 8 pcs Self-Tapping Anchor Screws to fix the Mounting Bracket on the ceiling.

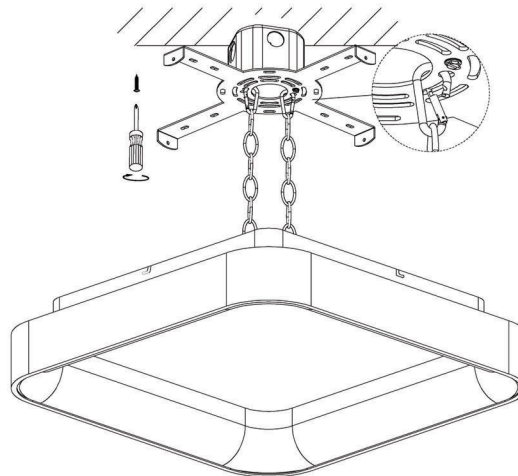

Attention: Must secure mounting plate at all connection points (junction box plus four outer points for small and medium size, or eight outer points for large size) to support fixture weight appropriately. Not using all mounting points could damage the fixture and void product warranty.

Step 6

Use wire connectors to connect L, N, G, DIM+, and DIM- wires. After finishing, put all wires with the connector into J-Box.

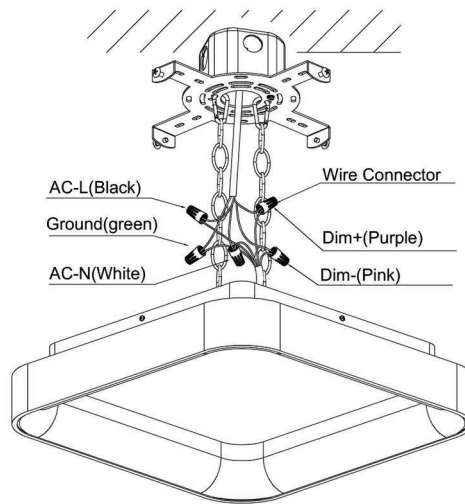

Step 7

Keep the Slot hole as a vertical line with a side screw, and make the screw into slot, then rotate the lamp body, finish fixing it.

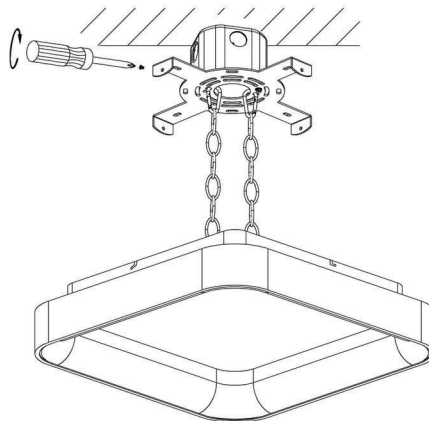

Step 8

After finishing installation, turn on the electricity at the main fuse box, and the lighting works.

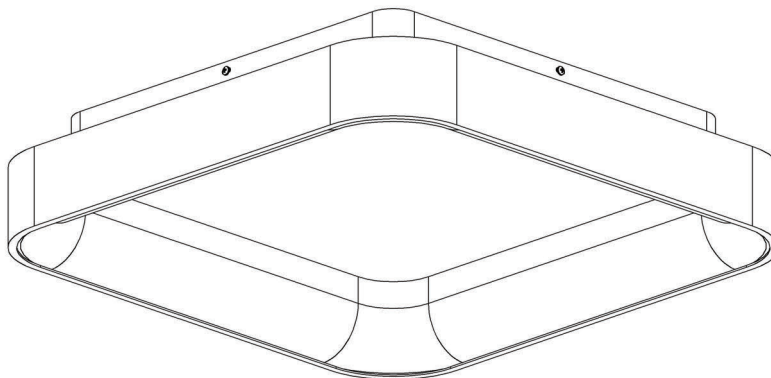

Circuit Box

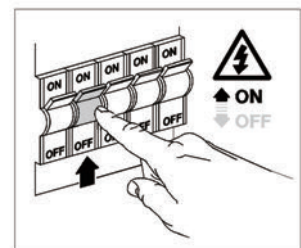

Warnings

- MIN 90 °C SUPPLY CONDUCTORS/LES FILS D'ALIMENTATION 90 °C MIN
- DAMP LOCATIONS ONLY/POUR EMPLACEMENTS SECS SEULEMENT
- CAUTION – RISK OF FIRE/ATTENTION – RISQUE D'INCENDIE
THIS PRODUCT MUST BE INSTALLED IN ACCORDANCE WITH THE APPLICABLE INSTALLATION CODE BY A PERSON FAMILIAR WITH THE CONSTRUCTION AND OPERATION OF THE PRODUCT AND THE HAZARDS INVOLVED/CE PRODUIT DOIT ÊTRE INSTALLÉ SELON LE CODE D'INSTALLATION PERTINENT, PAR UNE PERSONNE QUI CONNAÎT BIEN LE PRODUIT ET SON FONCTIONNEMENT AINSI QUE LES RISQUES INHÉRENTS
- Application temperature for ring light is -20°C~40°C, humidity is 0~95%. Otherwise, it may be harmful for the lifespan of the ring light.
- Please TURN OFF POWER before installation. This lamp must be installed and maintained by an electrician or qualified personnel.
- Pay attention to fire prevention, electricity, and shock resistance.
- Please do not cover the combustibles on the fixture.
- All screws and terminals should be tightened and tightly inserted. No loosening and improper connection are allowed. Attention should be paid to the polarity of components, power supply, driver, and so on.
- Terminals should be tightened and tightly inserted. No loosening and improper.