

| | | |
|----------|--|----|
| AC [V]e± | | 5V |
| Uj aV± | | |
| > Uj aV± | | |

LSP-C Series SOLAR LED Post Top

PRODUCT DESCRIPTION

- High brightness LED 20W LED Power.
- 25Ah 12.8V LITHIUM LIFE04 battery, with fast charging, working temperature 5°F to 149°F.
- 45 Watt Monocrystalline Solar Panel, Grade A Solar Cells.
- INTERPON AKZONOBEL coating.
- 5 Year Warranty.

PERFORMANCE SUMMARY

Delivered Light Output: 2,600 Lumens

Power: 20 Watts

CCT: 3000K, 4000K, 5000K

Standard Lifetime: Designed to L70 minimum 50,000 hours

IP Rating: IP65

Charging: 6 Hours / Day, direct sun light

Autonomy: 23 Hours

PHILIPS LUXEON Module

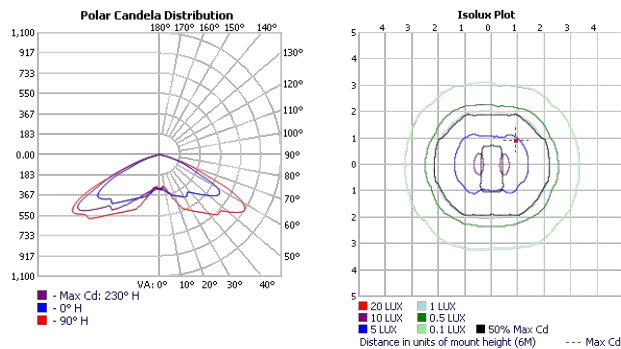
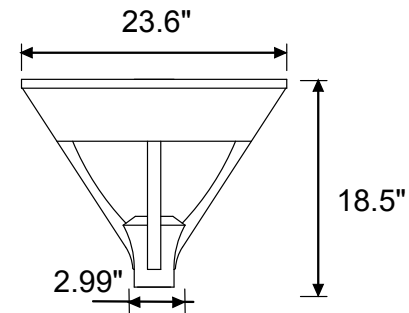

ORDER INFORMATION

EXAMPLE: LSP-C-20W-SP-40K-5M-16-BK-4MTR



| Series | Size | Watts | Voltage | CCT | Optics | Mount | Finish |
|--------|------|-------|----------------|---|--------|------------------|------------|
| LSP | C | 20W | SP=Solar Power | 30K = 3000K 40K = 4000K 50K = 5000K | 5M | 16 = Slip Fitter | BK = Black |

Enter configuration:

** Special Order / contact vendor

