

Project		Date
Type		
Model		

PARKING GARAGE

LVR Series LED Vapor Tight

CCT: 3500K

- The LUMINOSO LVR Series is corrosion, flame and vandal resistant.
- HOUSING: 100% UV stabilized polycarbonate, liquid silicone perimeter gasket with memory retention.
- DIFFUSER: Frosted UV stabilized polycarbonate diffuser, providing even light distribution.
- LUMENS: 50W (6,400Lm), 70W (9,170Lm)
- Efficacy: 128, 131 LPW
- LED Driver: 0-10V Dimming
- OPERATING TEMP: -25° to 104° (-25°C to 40°C)



WET | IP66 | IK05

APPLICATION: The LVR Series is specifically designed to meet requirements for parking structures, stairway, storage, etc.

ORDER INFORMATION

EXAMPLE: LVR-SM-70-35K-J-Y



Series	Mount	Wattage	CCT	Beam Angle	Voltage
LVR Vapor Tight	SM Surface Mount	50 50 Watts	35K 3500K	J 120°	Y Y = 120-277V
		70 70 Watts			

Enter configuration:

Dimensions and values shown are nominal. LuminosoLED continually works to improve products and reserves the right to make changes which may alter the performance or appearance of products.

EXTERNAL

- Polycarbonate, housing in gray finish is standard.
- Unique 3 piece design that allows for tool-less assembly feature.

POWER FEED

- Leads for quick in-field connection and hot load disconnect feature.
- 3-pole, quick connector for hot and neutral.

DIFFUSER

- Frosted UV stabilized polycarbonate diffuser, providing uniform light distribution.

EMERGENCY MODE

- Test switch provided.

DIMMING

- 0-10V dimming driver for 120-277V (1-100%).
- Compatible with most dimming systems, contact vendor for more information.

MOUNTING

- Surface mount configuration is standard with integrated stainless steel mounting brackets.

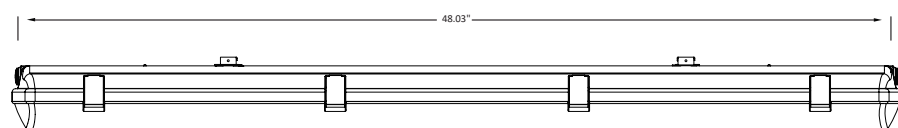
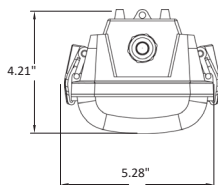

WEIGHT: 10 lbs. / 4.5 kg.

PERFORMANCE DATA

Model	Voltage	Power	CCT	Max Lumen	Lifetime	Dimension
LVR-50	120-277V	50W	3500K	6,400	50,000 hrs	48 x 5.28 x 4.2 in
LVR-70	120-277V	70W	3500K	9,170	50,000 hrs	48 x 5.28 x 4.2 in



DISTRIBUTION DIAGRAM

