

DESCRIPTION

This LED surface-mount fixture offers field-selectable CCT, allowing on-site selection of 3000K, 4000K, or 5000K for versatile application. It includes an optional microwave sensor with tri-level dimming, an advanced motion detection system that adjusts light output in three stages: full brightness (100%) when motion is detected, a reduced dimmed level (30%) during standby, and off when no motion is present. An emergency battery backup is also available, but can only be selected if the microwave sensor is not used, and vice versa. Designed for durability, the fixture is IP65 rated for dust and water resistance and IK10 rated for high-impact protection, making it ideal for demanding indoor and outdoor environments.

FEATURES

- Die-cast aluminum housing, finished with powder coating.
- LED chip: standard 80 CRI.
- 120-277VAC 50/60Hz
- Optional Built in Microwave sensor, (100%, Dim 30%, Off).
- 3 CCT Selectable allows for further customization based on your requirements.
- Built in 6Kv Surge Protector.
- IK10 & IP65 Rated.
- Knock-out for side power feed.
- UV-resistant diffuser
- Operating Temperature: -4°F to 122°F
- Average life (L70) 50,000 hrs.

White
RAL9003

Black
RAL9005

Anthracite
RAL7016

Gray
RAL7045

Project:	Date
Type:	
Model:	



ORDER INFORMATION

EXAMPLE: LCC-18W-Y-CCTS-BK-MS



Series	Wattage	Voltage	CCTS	Finish	Shield Option	Sensor
LCC Surface Mount	18W 18 Watts	Y 120-277V	CCTS Selectable Color Temperature (3000K / 4000K / 5000K)	BK Black WH White AG Anthracite Gray GR Gray	(Blank) Standard E Eyelid C Cross G Grille	(Blank) Standard ON/OFF MS Microwave sensor tri-level dimming (corridor function); Daylight sensor.

Enter configuration:

**Special order 6-8 weeks

Dimensions and values shown are nominal. LuminosoLED continually works to improve products and reserves the right to make changes which may alter the performance or appearance of products.

LCC Surface Mount

LED Selectable CCT / ON/OFF or with Microwave Sensor



PERFORMANCE DATA

Model	CCT Selectable	Lumens	Efficacy	Wattage	Power Factor	Beam Angle	Voltage
LCC	3000K	1,530	80 lm/W	18W	>0.9	120°	120-277V
	4000K	1,600	85 lm/W				
	5000K	1,670	90 lm/W				



Without Motion Sensor



With Motion Sensor
Service-hinged PCB for
easy access & installation.

Tri-level Control HF Sensor

HC403VRC-KD

Detached Version with Daylight Monitoring and Remote Control

Applications:

Occupancy detector with tri-level dimming control suitable for indoor use.

- Office / Commercial Lighting
- Classroom
- Warehouse

DIP Switch settings

Sensitivity	10% / 50% / 75% / 100%
Hold-time	5s ~ 30min (Selectable)
Daylight threshold	2 ~ 50 lux, disabled
Stand-by period	0s ~ 1h, + ∞ (selectable)
Stand-by dimming level	10% / 20% / 30% / 50%

Environment

Operation temperature	Ta: -4°F to 140°F
Case temperature (Max.)	Tc: 176°F
IP Rating	IP20

DIMENSIONS

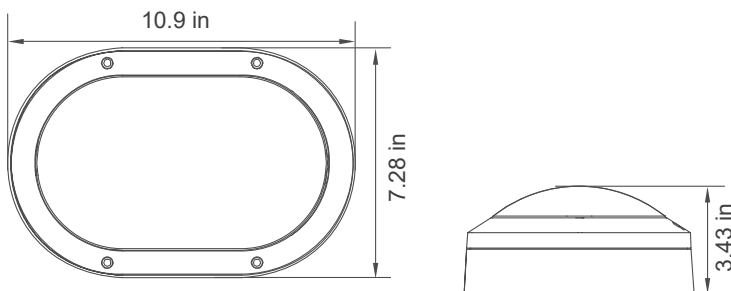

PHOTOMETRIC

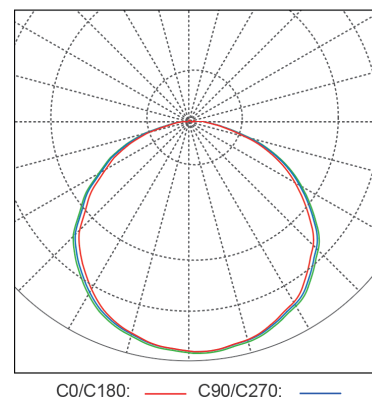

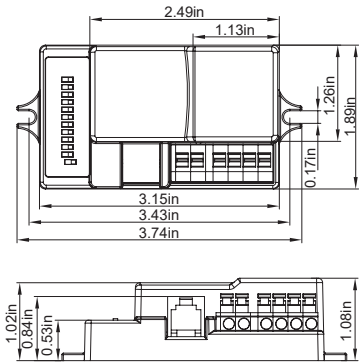
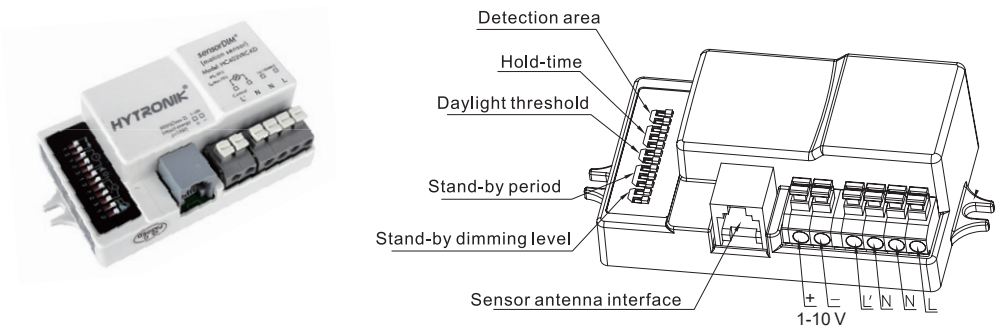

DIP Switch Settings

1 Detection Range

Sensor sensitivity can be adjusted by selecting the combination on the DIP switches to fit precisely for each specific application.

Table with 2 columns (1, 2) and 4 rows (I, II, III, IV) showing detection range settings (100%, 75%, 50%, 10%).

2 Hold-time

Choose the DIP switch position that sets how long the light stays at full brightness after presence is detected.

Note: This function is deactivated when ambient daylight exceeds the set daylight threshold for a continuous period of more than 5 minutes.

Table with 3 columns (1, 2, 3) and 7 rows (I, II, III, IV, V, VI, VII) showing hold-time settings (5s, 30s, 1min, 5min, 10min, 20min, 30min).

3 Daylight Threshold

Adjust the level based on the fixture and surroundings. The light will remain off if ambient light is above the daylight threshold.

Please note that the ambient lux level refers to the internal light measured at the sensor. When the daylight sensor is disabled, the device operates in occupancy detection only.*

Table with 2 columns (1, 2) and 4 rows (I, II, III, IV) showing daylight threshold settings (Disable, 50Lux, 10Lux, 2Lux).

4 Stand-by period (corridor function)

This defines the period during which the fixture maintains a low light output before fully turning off in the extended absence of occupants.

Note: "0s" = on/off control; "+ ∞" = infinite stand-by time, the fixture remains on continuously.

Table with 3 columns (1, 2, 3) and 8 rows (I, II, III, IV, V, VI, VII, VIII) showing stand-by period settings (0s, 10s, 1min, 5min, 10min, 30min, 1H, +∞).

5 Stand-by dimming level

This setting controls how bright the light stays when the area is unoccupied, ensuring comfort and safety.

Table with 2 columns (1, 2) and 4 rows (I, II, III, IV) showing stand-by dimming level settings (10%, 20%, 30%, 50%).