

## HLB Series LED High Bay

### PRODUCT DESCRIPTION

The Luminoso HLB series brings an all new sleek, low profile design to the world of LED high bay lighting. This product's design makes it a perfect replacement traditional High Bay fixtures. Its wide distribution angle is ideal for lighting applications such as gymnasiums, warehouses, manufacturing and service areas. Lastly, the HLB series' exceptional 50,000+ hours of operation and wattage reductions of over 65% from its traditional counterparts makes it a truly revolutionary product. It is available in either a 40, 60, 90, 120 and 200 watts, with lumen packages ranging from 4,510 to 23,100.

### PERFORMANCE SUMMARY

Efficacy: 110 Lm/W
Delivered Lumens Output: 4,510 - 23,100
Power: 40 - 200W
Power Factor: >0.95
CRI: 80
CCT: 4000K, 5000K
Input Voltage: 120 - 277 VAC
Frequency: 50-60Hz
Beam Angle: 110° Standard
Warranty: 5 Years
Standard Lifetime: designed to L70 minimum 50,000 Hours
Rating: IP43
Operating Temp: -40°F to 122°F
Dimmable Optional: 1-10V



### REGULATORY & VOLUNTARY QUALIFICATIONS

UL Listed  
Suitable for Wet Locations

### ORDER INFORMATION

EXAMPLE: HLB-23-120W-40K-5R1-Y-BK



Series	Mounting	Wattage	CCT	Optics	Voltage	Finish	Options
HLB	23=Hanging kit	40W 60W 90W 120W 200W	40K = 4000K 50K = 5000K	5R1	Y=120-277V	SV = Silver BK = Black	Blank = Standard DIM = 0-10V Dimming OO = On/Off Motion Sensor

Enter configuration:

\*\* Special Order / contact vendor

## Series / Performance

Series No.	HLB-40W	HLB-60W	HLB-90W	HLB-120W	HLB-200W
Power:	40W	60W	90W	120W	200W
Lumens:	4,510 (50K)	6,820 (50K)	10,010 (50K)	14,300 (50K)	23,100 (50K)
Efficacy:	110 LPW	110 LPW	110 LPW	110 LPW	110 LPW
Weight:	8.95 Lbs	8.95 Lbs	8.95 Lbs	17.84 Lbs	17.84 Lbs
Input:	120-277V AC	120-277V AC	120-277V AC	120-277V AC	120-277V AC

## Dimensions

40W / 60W / 90W

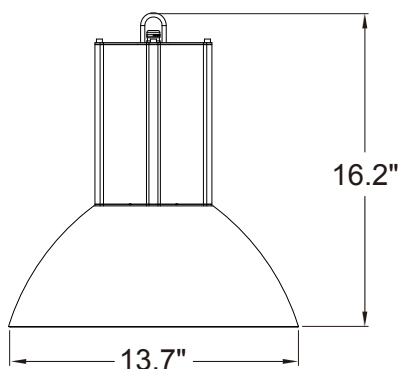

120W / 200W

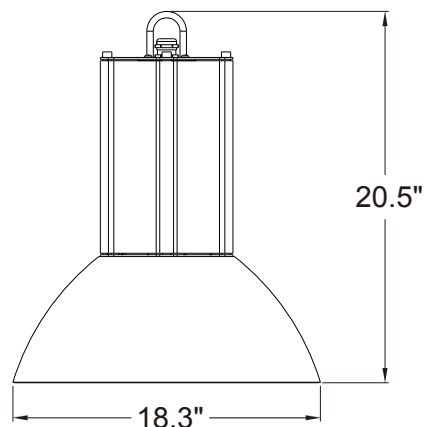

## Distribution Diagram

ISO Plot

**TSR**  
Reflector  
Typical use:  
Industrial

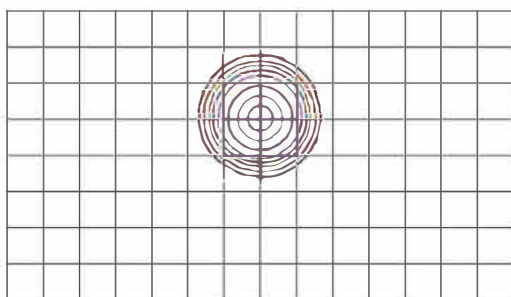

Polar Curve

